

WORLDWIDE FRACTIONAL HP MOTORS

Stainless Steel / Washdown Duty Motors

TEFC Enclosure ▪ C-Face ▪ Rigid Base and Round Body
Three-Phase ▪ 208-230/460 Volt

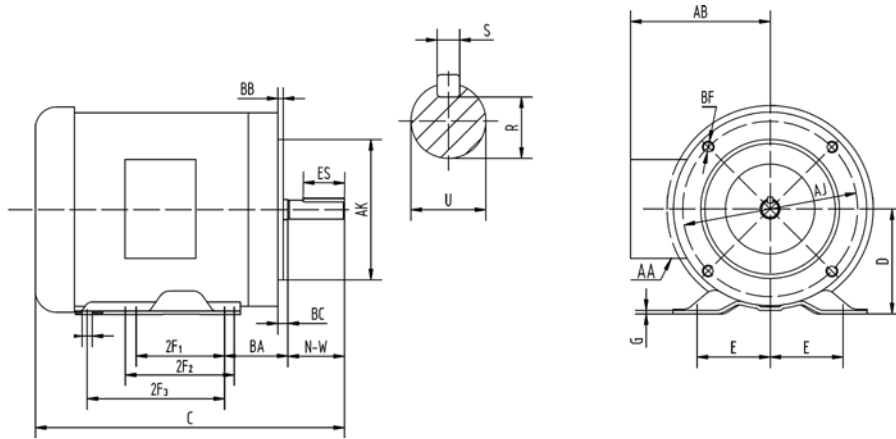

ALL DIMENSIONS IN INCHES

Model	E	2F1	2F2	2F3	H	BA	C	D	G	AB	S	ES	R	N-W	U	AA	BC	AK	AJ	BF	BB
WSS13-18-56CB	2.44	3	4	—	0.34	2.75	11.77	3.5	0.12	5.39	0.188	1.41	0.517	1.88	0.625	0.86	0.19	4.5	5.875	3/8 - 16	0.16
WSS12-36-56CB	2.44	3	4	—	0.34	2.75	11.77	3.5	0.12	5.39	0.188	1.41	0.517	1.88	0.625	0.86	0.19	4.5	5.875	3/8 - 16	0.16
WSS12-18-56CB	2.44	3	4	—	0.34	2.75	11.77	3.5	0.12	5.39	0.188	1.41	0.517	1.88	0.625	0.86	0.19	4.5	5.875	3/8 - 16	0.16
WSS34-36-56CB	2.44	3	4	—	0.34	2.75	12.76	3.5	0.12	5.39	0.188	1.41	0.517	1.88	0.625	0.86	0.19	4.5	5.875	3/8 - 16	0.16
WSS34-18-56CB	2.44	3	4	—	0.34	2.75	12.76	3.5	0.12	5.39	0.188	1.41	0.517	1.88	0.625	0.86	0.19	4.5	5.875	3/8 - 16	0.16
WSS1-36-56CB	2.44	3	4	5	0.34	2.75	12.76	3.5	0.12	5.39	0.188	1.41	0.517	1.88	0.625	0.86	0.19	4.5	5.875	3/8 - 16	0.16
WSS1-18-56CB	2.44	3	4	5	0.34	2.75	12.76	3.5	0.12	5.39	0.188	1.41	0.517	1.88	0.625	0.86	0.19	4.5	5.875	3/8 - 16	0.16
WSS1.5-36-56CB	2.44	3	4	5	0.34	2.75	12.76	3.5	0.12	5.39	0.188	1.41	0.517	1.88	0.625	0.86	0.19	4.5	5.875	3/8 - 16	0.16
WSS1.5-18-56CB	2.44	3	4	5	0.34	2.75	12.76	3.5	0.12	5.39	0.188	1.41	0.517	1.88	0.625	0.86	0.19	4.5	5.875	3/8 - 16	0.16
WSS2-36-56CB	2.44	3	4	5	0.34	2.75	13.50	3.5	0.12	5.39	0.188	1.41	0.517	1.88	0.625	0.86	0.19	4.5	5.875	3/8 - 16	0.16
WSS2-18-56CB	2.44	3	4	5	0.34	2.75	13.50	3.5	0.12	5.39	0.188	1.41	0.517	1.88	0.625	0.86	0.19	4.5	5.875	3/8 - 16	0.16
WSS13-18-56CRD	—	—	—	—	—	—	11.77	—	—	5.39	0.188	1.41	0.517	1.88	0.625	0.86	0.19	4.5	5.875	3/8 - 16	0.16
WSS12-18-56CRD	—	—	—	—	—	—	11.77	—	—	5.39	0.188	1.41	0.517	1.88	0.625	0.86	0.19	4.5	5.875	3/8 - 16	0.16
WSS34-18-56CRD	—	—	—	—	—	—	12.76	—	—	5.39	0.188	1.41	0.517	1.88	0.625	0.86	0.19	4.5	5.875	3/8 - 16	0.16
WSS1-18-56CRD	—	—	—	—	—	—	12.76	—	—	5.39	0.188	1.41	0.517	1.88	0.625	0.86	0.19	4.5	5.875	3/8 - 16	0.16
WSS1.5-18-56CRD	—	—	—	—	—	—	12.76	—	—	5.39	0.188	1.41	0.517	1.88	0.625	0.86	0.19	4.5	5.875	3/8 - 16	0.16
WSS2-18-56CRD	—	—	—	—	—	—	13.50	—	—	5.39	0.188	1.41	0.517	1.88	0.625	0.86	0.19	4.5	5.875	3/8 - 16	0.16

Dimensions shown in this catalog are for general use only.
For an exact drawing on a specific rating, please contact our sales office.

